

By air mail  
Par avion



0127435  
DR M S SWAMINATHAN  
INTERNATIONAL RICE RESEARCH  
INSTITUTE  
P O BOX 933  
MANILA  
PHILIPPINES



PRESIDENT : HIS ROYAL HIGHNESS THE PRINCE PHILIP · DUKE OF EDINBURGH KG

LONDON *14<sup>th</sup> October 1985*

*Sir,*

*I have the honour to inform you that you were this day  
elected a Fellow of the Royal Society for the Encouragement  
of Arts, Manufactures and Commerce.*

*I am, Sir,*

*Your obedient Servant,*

*Alman*

SECRETARY

*Mr. Monkombu Sambasivan Swaminathan, BSc, PhD, FRS*



THE ROYAL SOCIETY *for the encouragement*  
OF ARTS *Manufactures and Commerce*

JOHN ADAM STREET · ADELPHI · LONDON WC2N 6EZ

TEL: 01-930 5115 TELEX: 892351

The Secretary has pleasure in enclosing the following papers and documents in connection with your recent election to Fellowship of the Society:

Diploma of Fellowship (*between cardboard sheets*)

Bankers' Order Form

Note on payment of subscription under Deed of  
Covenant

Note on the use of the letters "F.R.S.A."

Book of passes to meetings

List of Library Rules

A/No. 05309476

180002

MICHAELMAS

BANKERS' ORDER

As it is found convenient by many Fellows to pay their subscription by means of a permanent cheque on their Bankers, this form is offered for the purpose. The Secretary will be much obliged if Fellows will make use of it, as it greatly facilitates the collection of subscriptions.

REF. 0127635

ROYAL SOCIETY OF ARTS

..... 19 .....

To .....  
(Name and Address of Bank)

I request that you will on MICHAELMAS (29th September) 1986 pay to MESSRS. COUTTS & CO., 440 Strand, London W.C.2, to the credit of the ROYAL SOCIETY OF ARTS, the sum of TWENTY EIGHT POUNDS, and that you will continue the payment thereof on each succeeding MICHAELMAS (29th September) until further notice.

(Signed) .....

(Block Letters) .....



THE ROYAL SOCIETY *for the encouragement*  
OF ARTS *Manufactures and Commerce*

JOHN ADAM STREET · ADELPHI · LONDON WC2N 6EZ · TEL: 01-930 5115 TELEX: 892351

PAYMENT OF SUBSCRIPTIONS UNDER  
DEED OF COVENANT

Members may, if they wish, pay their annual subscriptions under deed of covenant. This concession means that, under a four year deed of covenant, the Society, at no extra cost to Fellows, will be able to recover the tax deducted at source from subscriptions paid by Fellows who are subject to United Kingdom income tax. The value to the Society of a net subscription of £28.00 a year made under covenant would thus be increased to ~~£40.00~~ <sup>39.44</sup> by the recovery of ~~£12.00~~ <sup>11.44</sup>

Subscriptions under deed of covenant, however, are not appropriate to Fellows who

- (i) have no income subject to United Kingdom tax or
- (ii) are allowed personal tax relief on their subscriptions.

Many Fellows already find it convenient to pay their subscriptions by banker's order. Members who decide to pay their subscriptions under covenant may wish to make a similar arrangement, and a banker's order form is enclosed for this purpose.

The Society is required to submit deeds of covenant to the Board of Inland Revenue for scrutiny. It will be appreciated, therefore, if Fellows electing to pay their subscriptions in this way will be kind enough to forward the deed to the Society as soon as possible after completion.

The Society will in respect of the first operative year of the deed send to all Members a copy of Inland Revenue form R 185 for completion.

CHRISTOPHER LUCAS

*Secretary*

1986 is  
INDUSTRY  
YEAR

# FORM OF COVENANT

I .....

*(insert full name, title or style, and address in block letters)*

.....  
.....  
.....

hereby Covenant with the Royal Society of Arts, 6/8 John Adam Street, Adelphi, London, WC2N 6EZ to pay for the purposes of the said Society from my general fund of taxed income during the year ending ..... - 5 APR 1987 ..... next and in each of the three succeeding years provided I shall so long live such yearly sum as after the deduction of the basic rate of income tax at the rate for the time being in force will leave a net yearly sum of Twenty Eight Pounds, £28.00.

In Witness whereof I have hereunto set my hand and seal this ..... day of ..... 19.....

.....  
(Signature)

Signed, Sealed and Delivered by the said ..... in the presence of

..... (Signature of Witness)

..... (Address)

.....

..... (Occupation)

## USE OF THE LETTERS 'F.R.S.A.'

The Privy Council has drawn the Society's attention to the proliferation of letters used by the members of professional organizations and other bodies, and expressed its concern about the growth of the practice of using these letters when such use tends to suggest a professional qualification in cases where none exists.

The Council of the Society has given much thought to this representation, for it has considerable sympathy with the views of the Privy Council. The Society itself has always been at pains to emphasize that the letters 'F.R.S.A.' should not be used in such a way as to suggest a professional qualification, and their use has been restricted by Bye-Law 61, which reads:

Any member of the Society . . . is authorized to use the style or title of 'Fellow of the Royal Society of Arts' or to use after his name the initials 'F.R.S.A.' to indicate such membership, but not for business or advertising purposes . . .

The principle expressed in the Bye-Law is therefore in line with the views of the Privy Council.

Broadly speaking, the Council thinks that it is better that Fellows should only use the letters where their use could not give rise to any misunderstanding.

(a) Thus, the letters should not be used by themselves whenever there is a possibility that they may be misleading or be thought to indicate a professional qualification. For example, the description 'John Brown, F.R.S.A., Artist', or 'Architect', conflicts with the Bye-Law.

(b) On the other hand, if a Fellow possesses a well recognized professional qualification there is less objection to the Society's letters being added afterwards, e.g., 'John Brown, R.I.B.A., F.R.S.A.', as there then is less possibility of doubt. The professional qualification, however, should be one which is widely known and of recognized standing.

(c) Normally there is no objection to Fellows using the letters in publishing articles or as authors of books, though it is preferable in such cases for the full description to be given after their names, e.g. 'John Brown, Fellow of the Royal Society of Arts'.

(d) There is no objection to the letters being used in reference books, where Fellows may quite properly wish to indicate their membership of the Society.

If Fellows are in any doubt as to when or how they may use the designation they are invited to consult the Secretary, who will be pleased to advise them.

The Council believes that all Fellows will wish to co-operate in observing the spirit of the Bye-Law and in ensuring that membership of the Society is not used for self-advertisement, as only by such co-operation can the Fellowship of the Society be maintained at its present high level.

# ROYAL SOCIETY OF ARTS

JOHN ADAM STREET, ADELPHI, LONDON, WC2N 6EZ

*Founded in 1754 for the Encouragement of Arts, Manufactures and Commerce*

PATRON: HER MAJESTY THE QUEEN

PRESIDENT: H.R.H. THE PRINCE PHILIP, DUKE OF EDINBURGH, K.G.

Every Fellow normally has the privilege of admitting two friends to all the Society's Meetings (with the exception of the Juvenile Lectures), and is entitled to issue these passes when unable to introduce visitors personally.

Fellows require no tickets for themselves, but are admitted on signing their names.

A further supply of tickets can be obtained on application to the Secretary.

# ROYAL SOCIETY OF ARTS

JOHN ADAM STREET, ADELPHI, LONDON, WC2N 6EZ

---

PATRON: HER MAJESTY THE QUEEN

PRESIDENT: H. R. H. THE PRINCE PHILIP, DUKE OF EDINBURGH, K.G.

---

*Admit Bearer to the Meeting on*

*(date)* .....

*Fellow's Signature* .....

*PROCEEDINGS OF THE SOCIETY*

ORDINARY MEETINGS.—Wednesdays; weekly during the Session.

CANTOR LECTURES.—Mondays at 6 p.m.; two or three Courses in each Session.

COMMONWEALTH SECTION.—Tuesdays and Thursdays at 5.15 p.m. About twelve meetings throughout the Session. Tea is served beforehand.

FILM EVENINGS.—Four during the Session.

*N.B.*—Particulars of the Lectures and Papers are given regularly in the Society's *Journal*.

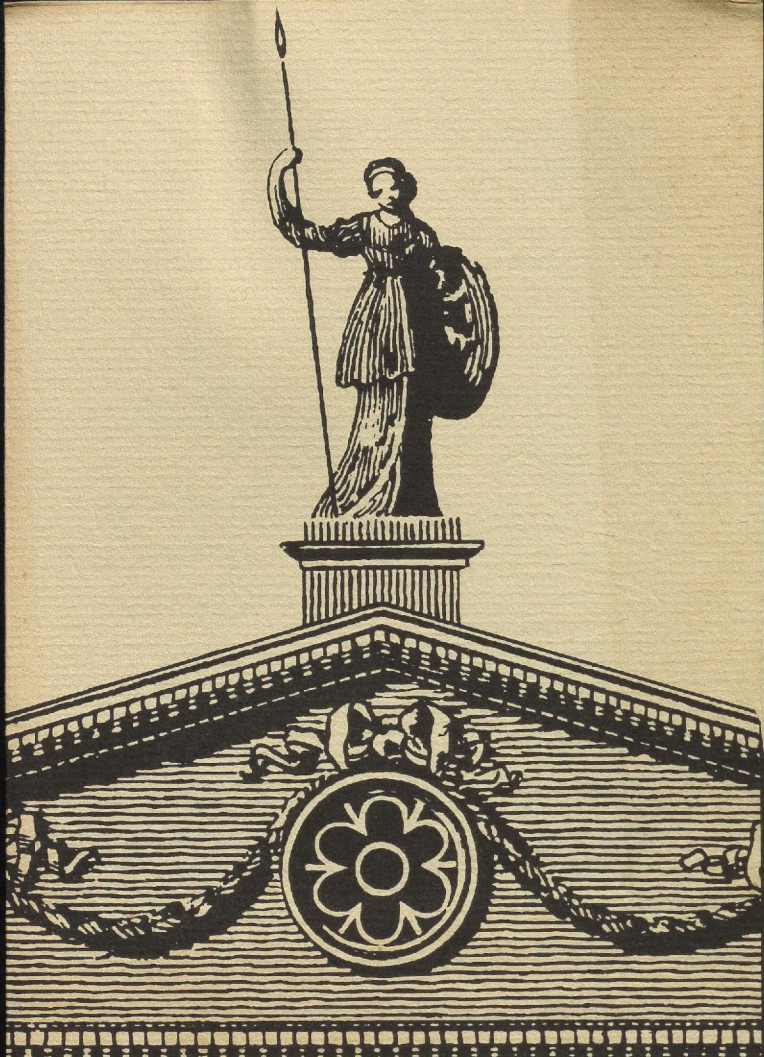

ENCOURAGEMENT OF ARTS

THE ROYAL SOCIETY FOR THE

MANUFACTURES & COMMERCE

*THE*  
*ROYAL SOCIETY*  
*OF ARTS*  
*LIBRARY*

★ F O U N D E D I N 1 7 5 4 ★

# THE ROYAL SOCIETY OF ARTS LIBRARY

## Contents

The Society's Library is divided into three sections:

- I *The lending section*, which contains over 5,000 books devoted mainly to the background of the Society's history (including technological, economic and art history) and to art and design.
- II *The reference section*, which contains about 3,000 books, covers the same subject range as the lending section and three special collections:
  - (i) the early library of the Society, with other works published before 1830
  - (ii) the catalogues, jury reports, etc. of the great international exhibitions
  - (iii) publications of the firm of Batsford down to 1945.
- III *The Society's early archives*, consisting of approximately 10,000 M.S. items of the 18th and early 19th centuries.

## Admission

The Library is located on the first floor of the Society's headquarter buildings and can be reached by lift or staircase. It is generally open 9.30-5.30 p.m. Monday to Friday inclusive, except at certain holiday periods. It is intended for the use of Members of the Society (i.e. Fellows, Associates, and Representatives of Institutions in Union and Companies in Association with the Society), and— for reference purposes only—by bona fide research students and historians.

## Conditions of Borrowing

Up to five volumes at a time may be borrowed by any one Member and retained for a period of six weeks, but the Curator-Librarian may at any time recall any book on loan which is required by another Member. The borrowing period may be extended on application to the Curator-Librarian. A fine of 25p a book, per month (portions of a month to count as a full month), may be imposed if a book is not returned on request after the expiry of the normal borrowing period of six weeks\*. Members living outside London may borrow books by post. Any books so borrowed are sent at the cost of the Society and returned at the cost of the borrower. Books may not be sent out of the United Kingdom.

## Card Catalogue

All books and periodicals are listed in the card catalogue by author and subject. White cards indicate a loans book, yellow cards a reference book and blue cards a periodical or lectures and papers printed in the Society's *Journal*. Classification is by the Dewey Decimal System.

## Location of Books

The reference section begins on the wall opposite the entrance and the lending section on the north wall of the Adelphi Room. In general the books are arranged according to their classification number.

## Periodicals

Current numbers as well as bound volumes are to be found in the Fellows' Room. The bound volumes are kept either in the locked glass shelves in the Fellows' Room (keys may be obtained from the Assistant Librarian) or in the Library basement. In some cases early volumes are stored in the Library basement. A list of the periodicals taken is available, and in most cases back issues of periodicals may be borrowed after binding.

## Book Lists

Book lists of the Library's holdings in select subjects are available for home reference.

## British Library Document Supply Centre

The Library is a registered user of the British Library Document Supply Centre and is thus able to locate and borrow books for Members through the scheme. When requesting a book from the B.L.D.S.C. it is essential to supply details of *author, title, publisher and date*. Without this information the request will not be handled by the B.L.D.S.C.

## Study Group

Members and others interested in the Society's history are invited to attend the Curator-Librarian's History Study Group. Details appear in the *Journal* and Lecture Programme.

## History of the Library

Although the Society had already built up a substantial collection of books by the time the house in the Adelphi was built, no clear indication appears from the records of any one room being set aside by the Society as a Library in the period 1774-1850. It seems the books were kept in various places, particularly the Committee Room on the first floor. Then when the Society's Museum and 'Repository' was dismantled in the middle of the nineteenth century, the present 'Benjamin Franklin Room' on the ground floor was converted for library use. The Library remained in the Benjamin Franklin until 1971, in which year it was moved to its present position, the former drawing room of No.2 John Adam Street. In 1980 it was extended into the 'Adelphi Room' (the chief public room of the Adelphi Tavern and Coffee House, built like no.2 c.1770-71). The rooms housing the Library contain several interesting architectural features. There are two original decorated plaster ceilings designed by Robert Adam, two mid-Georgian wooden chimney pieces brought from Bowood House, Wiltshire, in 1957 and slightly earlier carved door pediments which came from Fineshade Abbey in Northamptonshire in the same year and were placed in their present position in 1980. The painted roundels in the ceiling of the Adelphi Room depict Pan celebrating the feast of Bacchus and are in the style of Antonio Zucchi (1726-95) and his wife Angelica Kauffman (1741-1807).

\* Regulation prescribed by the Council pursuant to Bye-Law 60

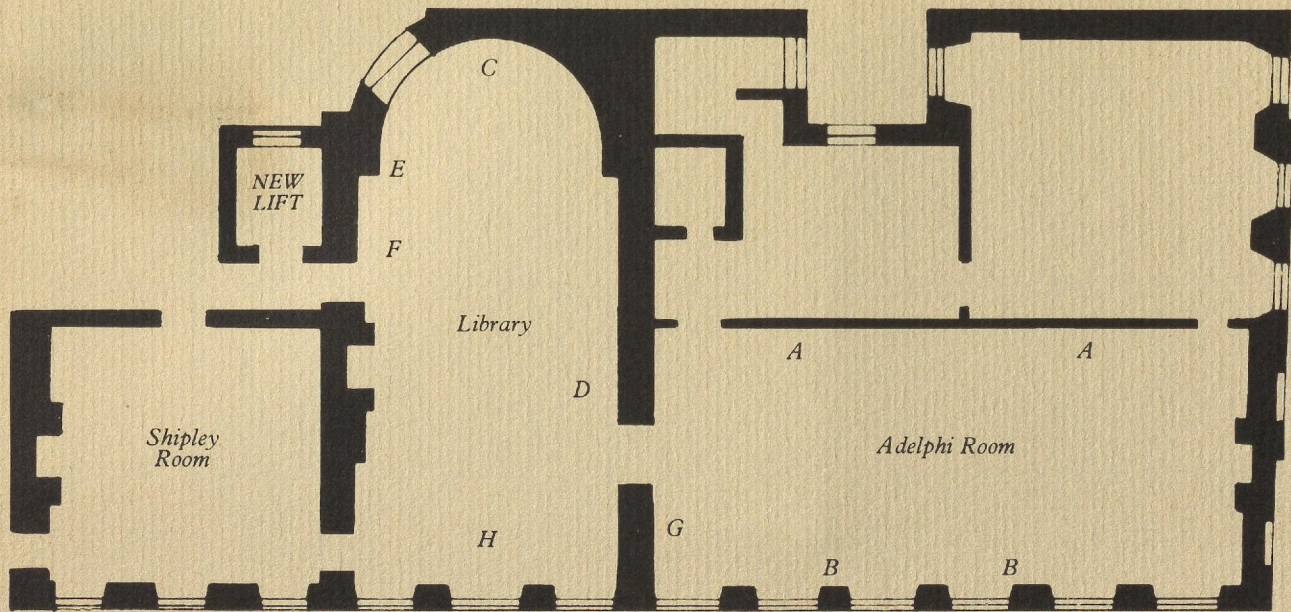

- A Lending stock
- B Reference stock
- C Early works
- D Batsford collection
- E Exhibitions collection
- F Journal
- G Card catalogues
- H Enquiry desk



THE ROYAL SOCIETY *for the encouragement*  
OF ARTS *Manufactures and Commerce*

JOHN ADAM STREET · ADELPHI · LONDON WC2N 6EZ · TEL: 01-930 5115 TELEX: 892351

T I E

The Society issues a tie for the use of Members.

This is specially designed in Crimplene with the Society's monogram in terra-cotta on a plain charcoal grey background. The ties are made by Thresher & Glenny Ltd. The cost to Home Members is £4.75, including postage, and to Overseas Members £6.25 including postage by airmail and insurance (American and Canadian Fellows should send the equivalent in dollars). An order form is reproduced below.

ORDER FORM

To: Thresher & Glenny Ltd.,  
Lancaster Place (approach to Waterloo Bridge), Strand, London WC2E 7EN  
(Company registered in England No. 242453. Registered Office: as above)

As a member of the Royal Society of Arts please accept my order for ..... R.S.A. Tie(s)

I enclose a remittance for .....

NAME (Block letters please) .....

ADDRESS .....

.....

Date .....